Meeting: Traffic Management Meeting
Date: 29 January 2014
Subject: A6001 London Road, Biggleswade – Consider Representation on Proposed 40mph Speed Limit Extension

Report of: Jane Moakes, Assistant Director Environmental Services

Summary: This report seeks the approval of the Executive Member for Sustainable Communities - Services for the implementation of an extension to the 40mph speed limit in A6001 London Road, Biggleswade following the receipt of an objection.

Contact Officer: Nick Chapman
nick.chapman@amey.co.uk

Public/Exempt: Public

Wards Affected: Biggleswade South

Function of: Council

CORPORATE IMPLICATIONS

Council Priorities:

The proposal will improve road safety.

Financial:

The scheme is being funded via a section 278 agreement relating to the re-development of the retail park at the southern end of A6001 London Road.

Legal:

None from this report

Risk Management:

None from this report

Staffing (including Trades Unions):

None from this report

Equalities/Human Rights:

None from this report

Community Safety:

The proposal will improve road safety for all road users, including pedestrians.

Sustainability:

A reduction in vehicle speeds will encourage lower vehicle emissions and encourage walking and cycling.

RECOMMENDATION(S):

- a) That the proposals to extend the 40mph speed limit on A6001 London Road, Biggleswade be implemented as published.
- b) That the Executive Member notes Biggleswade Towns Council's request to lower the existing 40mph speed limit to 30mph.

Background and Information

1. A proposal has been published to extend the 40mph speed limit on A6001 London Road as a result of the planned re-development of the adjacent retail park and associated highway works. As part of the highway improvements it was decided that the 40mph speed limit should be extended southwards from the Pegasus Drive roundabout to the A1 trunk road roundabout. This length of road is currently subject to the national speed limit, 60mph for cars, and it was felt that a 40mph speed limit is more realistic on what is a relatively short length of road.
2. The 40mph speed limit extension proposal was formally advertised by public notice in November 2013. Consultations were carried out with the emergency services and other statutory bodies, Biggleswade Town Council and Ward Members.
3. A representation was received from Biggleswade Town Council. Whilst not objecting to the proposed 40mph speed limit extension, they have asked for a 30mph speed limit to be introduced from Holme Court Avenue to Pegasus Drive.
4. Bedfordshire Police do not object to the published proposal.

Responses and Conclusion

5. The thicker red line shown on the plan overleaf indicates the proposed 40mph speed limit extension. At the present time the 40mph speed limit on A6001 London Road extends from just north of Dunton Lane southwards to immediately south of Pegasus Drive and is shown in green on the plan overleaf. This is the length of road that the Town Council has asked to be lowered to 30mph. The lengths marked blue are 30mph at present and there are no proposals or requests to change them.

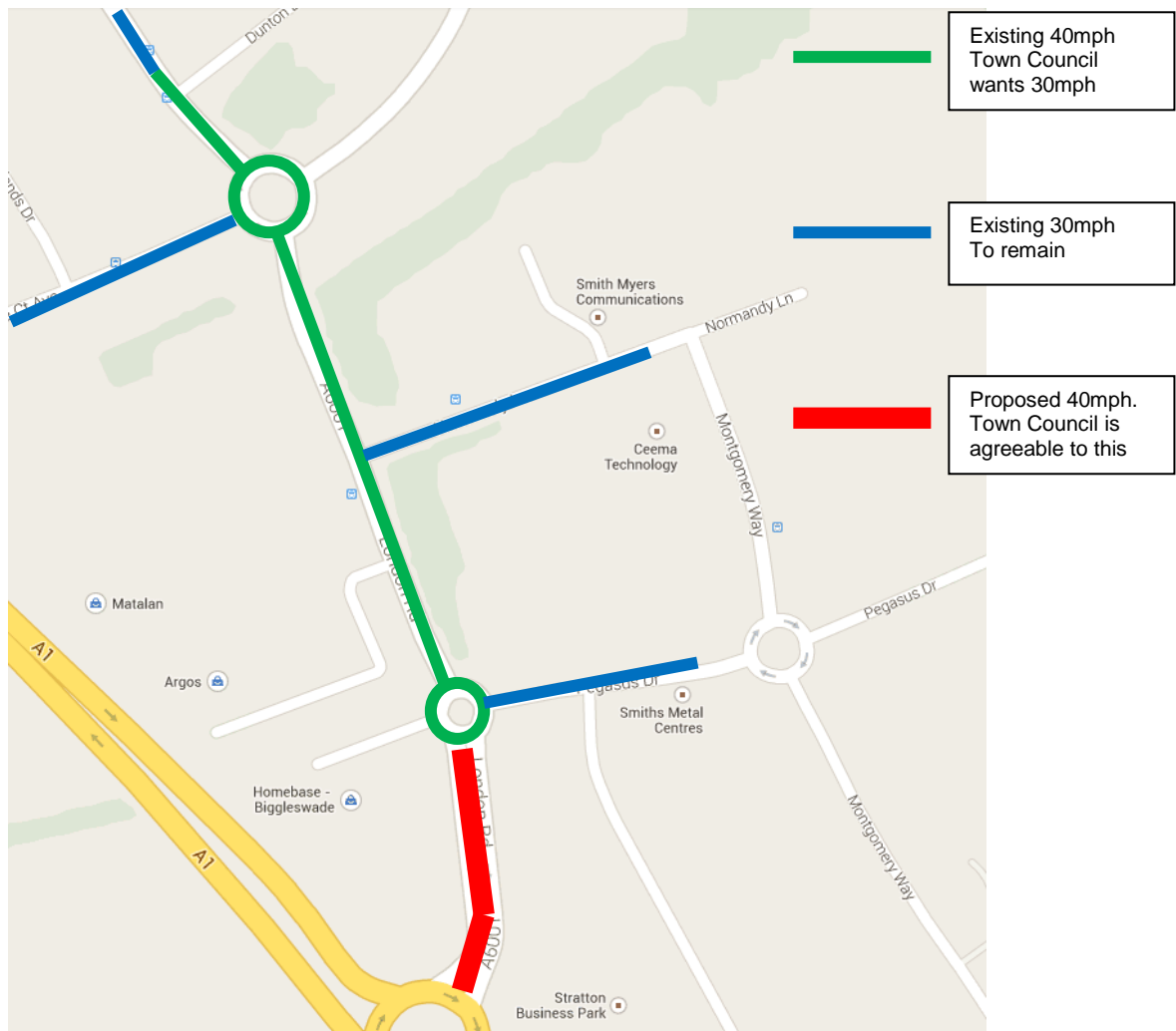

6. The highway improvements shown in Appendix D include the dualing of that length of A6001 London Road from Holme Court Avenue to Pegasus Drive, which are currently single carriageway. It is felt that a 40mph speed limit would be more appropriate for those lengths of road. A 30mph speed limit on what would be a wide dual carriageway would be poorly understood by drivers and compliance is likely to be poor.

In addition, there are no residential properties on this length of road to justify a 30mph speed limit. Pedestrian and cycle movements would be catered for by the provision of new toucan crossings, so there would be very little uncontrolled conflict between vehicular traffic and vulnerable road users.

If the Town Council's request was implemented, the remaining 40mph speed limit from Pegasus Drive to the A1 would be approximately 180 metres in length, which would be too short to be enforceable by the police and would be of limited value as a standalone speed limit.

7. It is considered that the retention of the existing 40mph speed limit together with the proposed extension is appropriate for the width, use and character of the road, so it is recommended that the proposal be implemented as published.

8. The developer has commenced work on the highway improvements and a temporary 40mph speed limit is in force. If approved, it is anticipated that the permanent 40mph speed limit will be implemented immediately.

Appendices:

Appendix A – Drawing of Proposed 40mph Speed Limit

Appendix B – Public Notice of Proposals

Appendix C – Objection

Appendix D – Proposed Highway Improvements

Appendix A

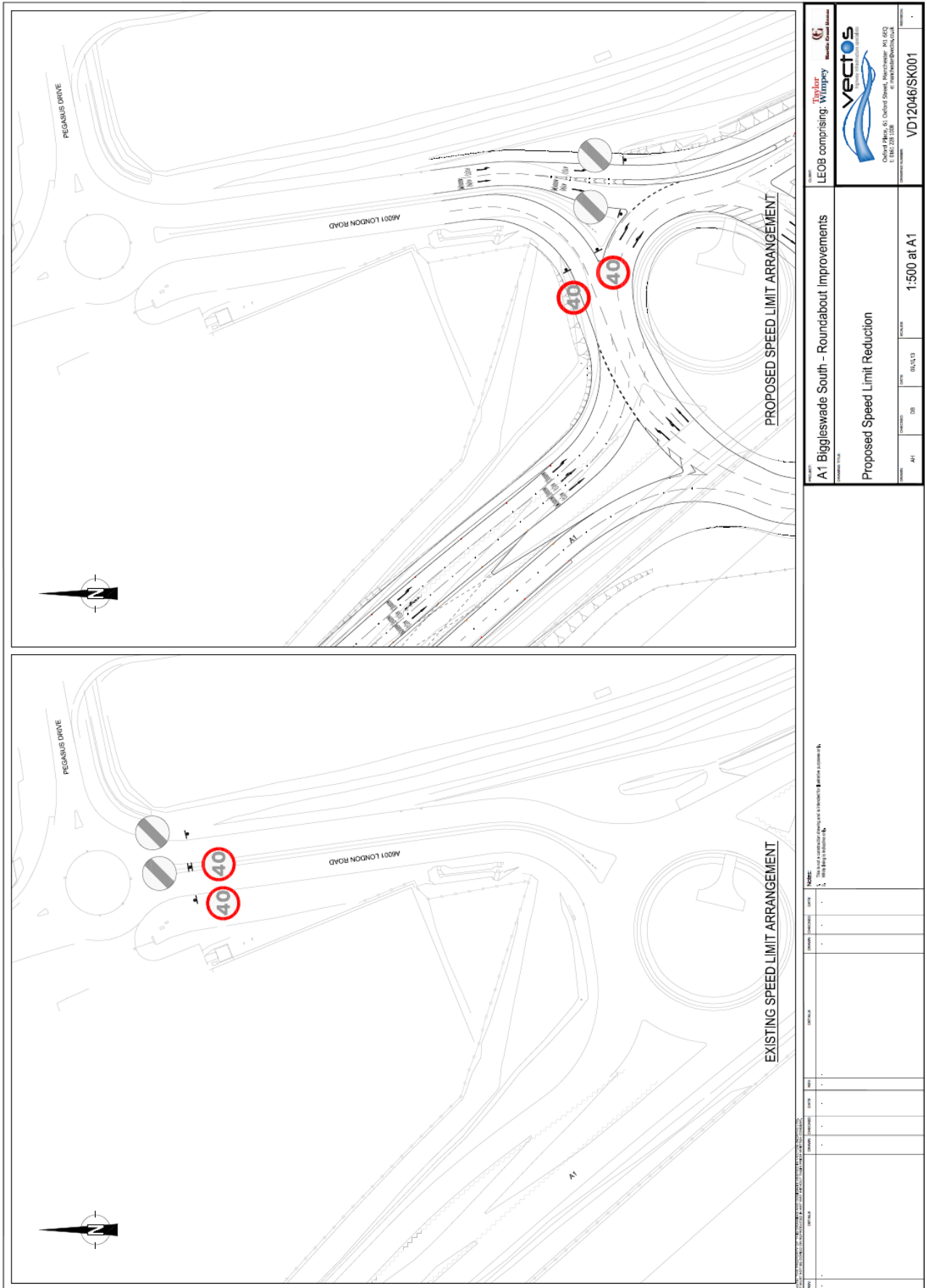

<p>PROJECT: A1 Biggleswade South - Roundabout Improvements</p> <p>LEOIB comprising: Wipacay</p> <p>Contract No: A1 Order Street, Biggleswade, MK43 0JQ T: 01525 228120 E: info@wipacay.co.uk</p> <p>VECTOS</p> <p>Contract Number: VD12046/SK001</p>	
<p>PROPOSED SPEED LIMIT REDUCTION</p> <p>PH</p>	<p>DATE: 01/11/13</p> <p>SCALE: 1:500 at A1</p>
<p>NOTES:</p> <ol style="list-style-type: none"> The speed limit zone is to be placed in accordance with the proposed arrangement. The speed limit zone is to be placed in accordance with the proposed arrangement. 	

PUBLIC NOTICE



Central
Bedfordshire

CENTRAL BEDFORDSHIRE COUNCIL PROPOSES TO EXTEND THE 40MPH SPEED LIMIT ON A6001 LONDON ROAD, BIGGLESWADE

Reason for proposal: The proposed Order is considered necessary for avoiding danger to persons or other traffic using the road or for preventing the likelihood of any such danger arising and for preserving or improving the amenities of the area through which the road runs. The proposal is related to a new retail development and associated highway improvements.

Effect of the Order:

To extend the 40mph Speed Limit on the following length of road in Biggleswade:-

A6001 London Road, from a point approximately 35 metres south of its junction with Pegasus Drive extending in a southerly direction to its junction with A1 London Road.

Further Details may be examined during normal opening hours at Biggleswade Library, Chestnut Avenue, Biggleswade SG19 0LL or online at www.centralbedfordshire.gov.uk/publicstatutorynotices. These details will be placed on deposit until 6 weeks after the Order is made or until it is decided not to continue with the proposal.

Objections should be sent in writing to the Transportation Manager, Bedfordshire Highways, Woodlands Annex, Manton Lane, Bedford MK41 7NU or e-mail centralbedsconsultation@amey.co.uk stating the grounds on which they are made by 3 December 2013.

Order Title If made will be "Central Bedfordshire Council (40mph Speed Limit) (A6001 London Road, Biggleswade) Order 2013"

Central Bedfordshire Council
Priory House
Chicksands
Shefford SG1917 5TQ

Marcel Coiffait
Director of Community Services

8 November 2013

Appendix C

At a meeting of the Town Council 12.11.13 the Town Council considered the above. The Town Council **RESOLVED** that a speed limit of 30mph is introduced from Holme Court Avenue to Pegasus Drive and a speed limit of 40mph from Pegasus Drive to the A1.

I hope that you will consider the Town Councils resolution.

Kind regards
Town Clerk

Appendix D

